

BefTec DS180 - Bitumen/Kunststoff/Blech

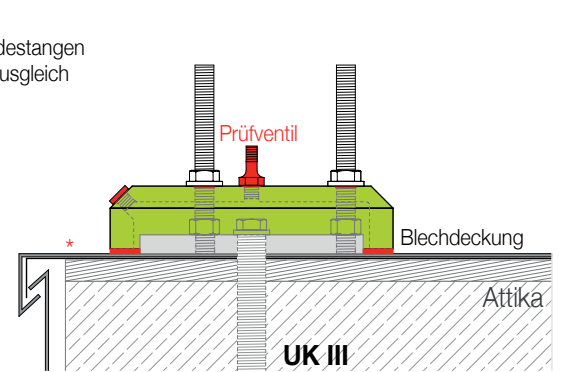
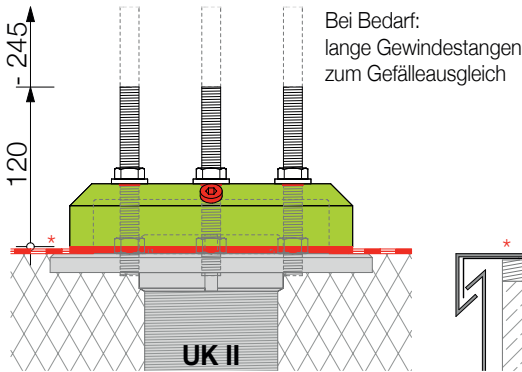
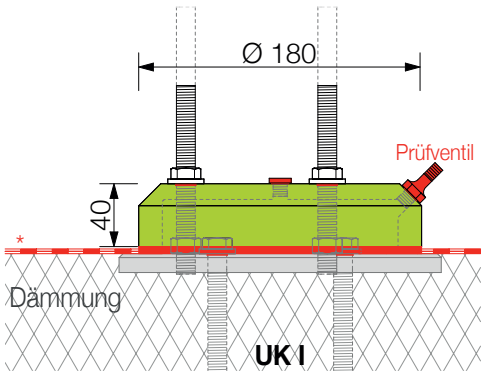
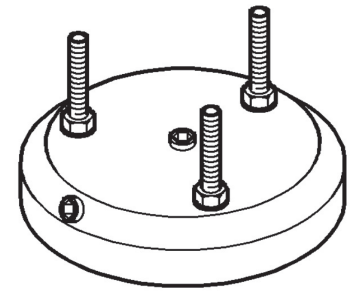
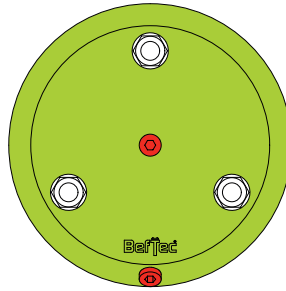
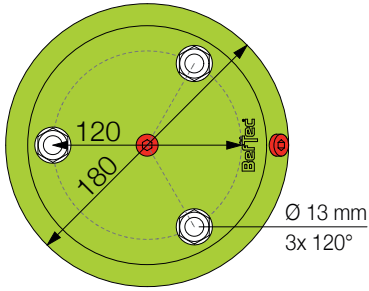

* Dachabdichtung = Bitumen | Kunststoff

* Bitumen | Kunststoff

* Blechdeckung

BefTec UNTERKONSTRUKTIONEN - Beton

UNTERKONSTRUKTION I - Beton

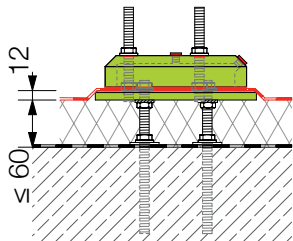
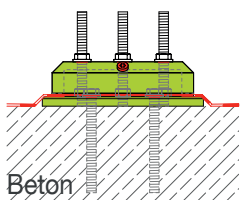
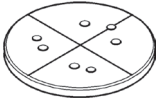

DS180 UK I
0 - 60 mm
Montageset 1.1 - B

DS180 UK I
0 - 60 mm
Montageset 1.2 - B

UNTERKONSTRUKTION II - Beton

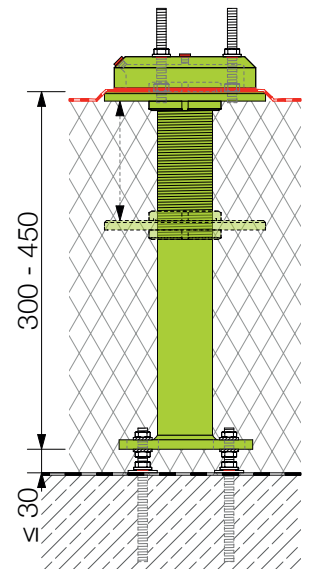
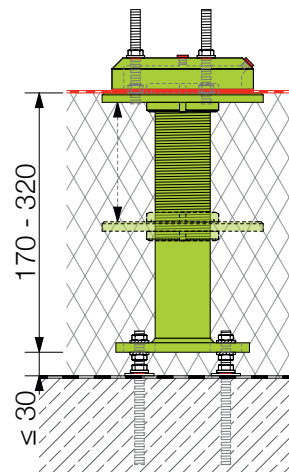
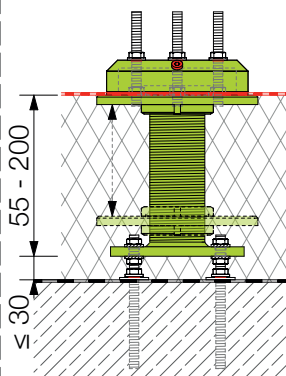
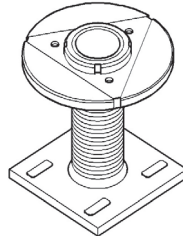

DS180 UK II - B
55 - 200 mm
Montageset 2 - B

DS180 UK II - B
170 - 320 mm
Montageset 2 - B

DS180 UK II - B
300 - 450 mm
Montageset 2 - B

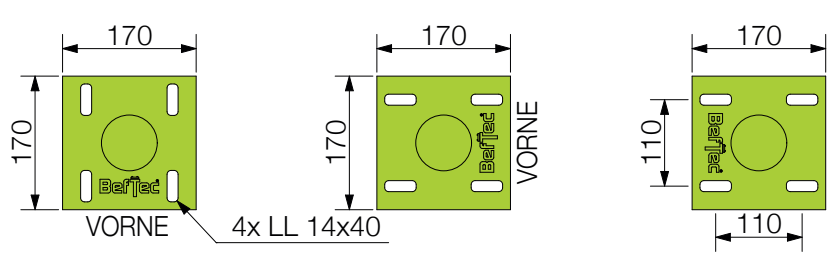
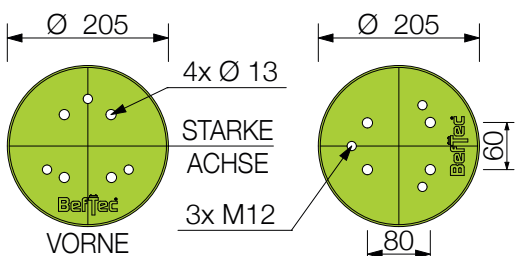

BefTec AUSGLEICHSPROFIL

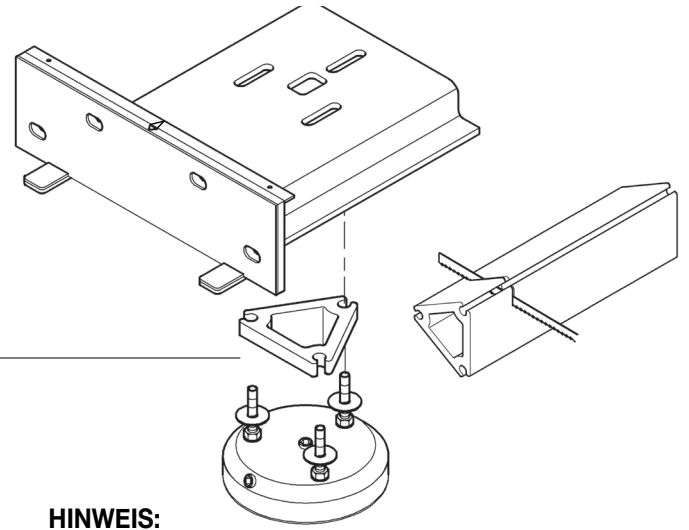
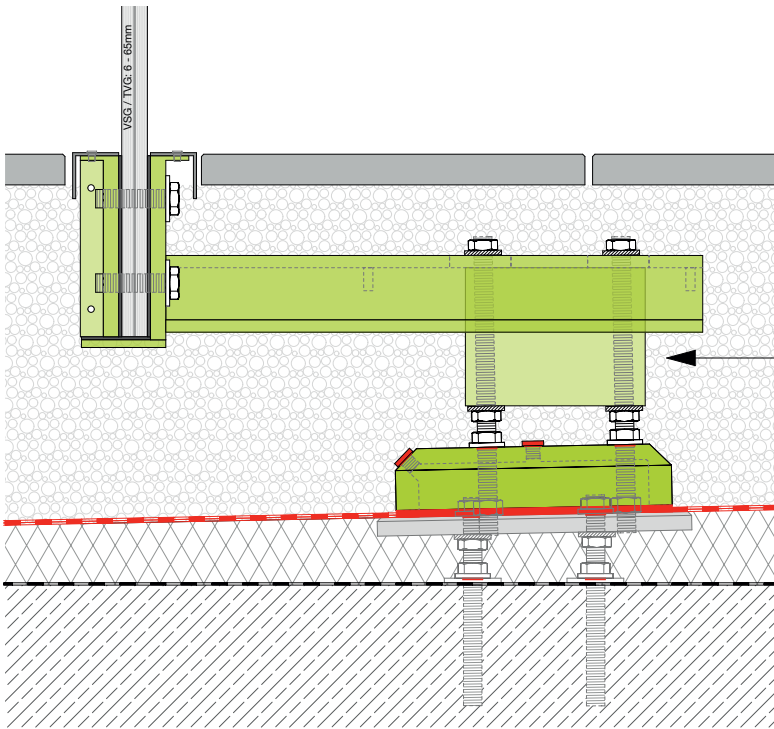

HINWEIS:

Profil zum Ausgleich von Fußbodenaufbauten bzw. Gefälledämmung.

Bei längeren Gewindestangen muss ein Ausgleichsprofil beigelegt werden!

BefTec UNTERKONSTRUKTIONEN - Holz/Hohldiele

UNTERKONSTRUKTION I - Holz

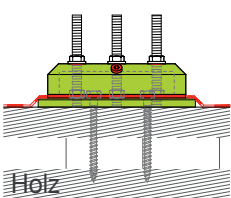
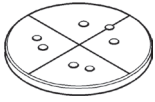

DS180 UK I

0 - 60mm

Montageset 1.1 - H
auf Anfrage

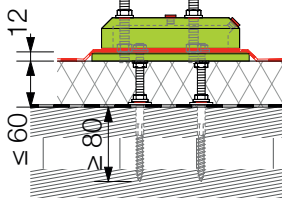

DS180 UK I

0 - 60mm

Montageset 1.2 - H
auf Anfrage

UNTERKONSTRUKTION II - Holz | Hohldiele

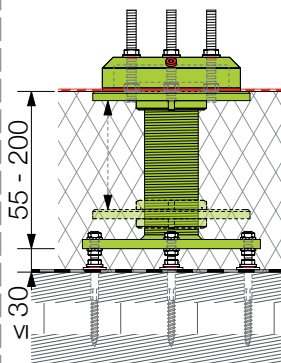
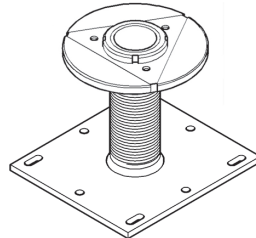

DS180 UK II - H

55 - 200mm

Montageset 2 - H
auf Anfrage

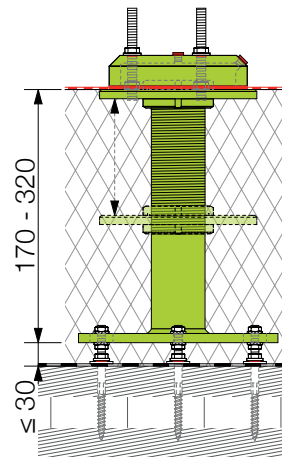

DS180 UK II - H

170 - 320mm

Montageset 2 - H
auf Anfrage

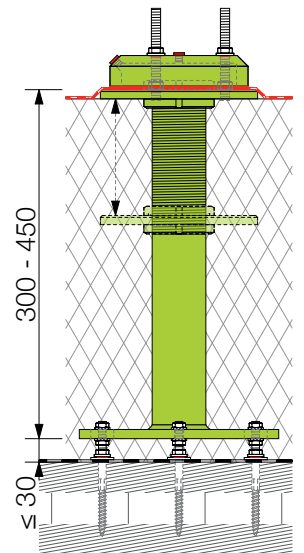

DS180 UK II - H

300 - 450mm

Montageset 2 - H
auf Anfrage

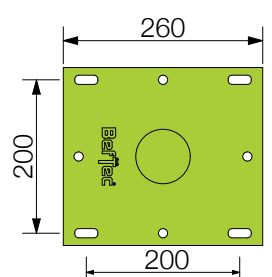
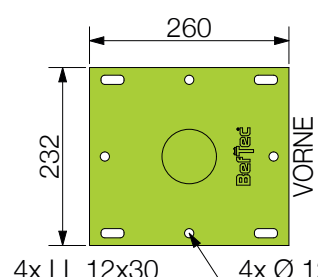
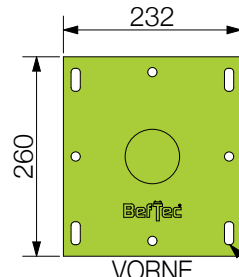
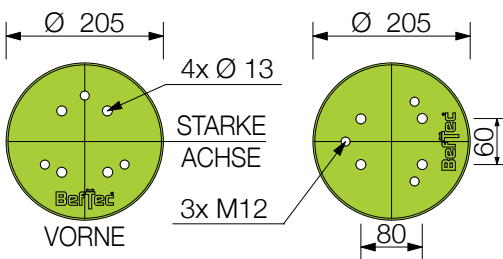

BefTec GLASKONSOLE 350



BefTec HUTPROFIL 350

